

Plastic bags into cardboard boxes.

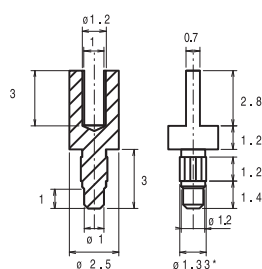

a	b	c	d	e	f
xxx	xxxx	ooo	x	x	o

- a** Family
- b** Type of terminal pin
- d** Used material (see references below)
- 2 Copper
- 4 Bronze
- 5 Brass
- e** Plating
- 0 Gold
- 0.2 μm over Ni 1.27 μm
- 4 Tin 5 μm over Ni 1.27 μm



31108150005X0